

## RI-CT248-EW Series

### easywire® Three Phase Current Transformers



- Patented technology
- Foot, busbar or DIN rail mounting
- RJ45 connector output
- Safe to leave transformer on load with output disconnected
- Fits standard moulded circuit breaker frame sizes
- From 150A to 630A Primary current input available
- 330mV output
- Sealable RJ45 connection
- 140mm width
- 45mm bar centres
- 31 x 31mm apertures



#### Product Description

The RI-CT248-EW is part of the **easywire®** family of current transformers and is one of five frame sizes available.

The **easywire®** system has been designed to save up to 90% installation time compared to a standard current transformer to meter installation.

This three phase current transformer is suitable for monitoring current in industrial and commercial applications and is designed to connect to the **easywire®** series of metering products.

Built-in limiting circuitry ensures the secondary of the current transformer is always under load and clamped to a safe level. This means that the output connection may be safely disconnected while under load.

Improved design features of these **easywire®** current transformers include a robust 'snap-on' DIN rail fixing, captive busbar location screw fittings, insulated busbar location feet, sealable (anti-tamper) RJ45 connection sockets and moulded load direction indication arrows on the CT shoulders.

#### Parameters

Primary Current	Output (RJ45)	Order Code
150A	330mV	0150
200A	330mV	0200
250A	330mV	0250
300A	330mV	0300
400A	330mV	0400
500A	330mV	0500
600A	330mV	0600
630A	330mV	0630

#### Options

The RI-CT248-EW is available with a horizontal RJ45 socket (stock) or a vertical RJ45 socket (to order).



## Rated Standard

Rated Primary Current ( $I_{pr}$ )	150...630A
Frequency Range ( $f_R$ )	47...63Hz
Rated continuous current	100% rated current
Rated short time thermal current ( $I_{th}$ )	<60 $I_n$
Rated dynamic current ( $I_{dyn}$ )	2.5 $I_{th}$
Instrument security factor (FS)	≤5
Rated Secondary output ( $V_{sr}$ )	330mV
Accuracy class	Class 1 to IEC/EN60044-8 & IEC/EN61869-2
Rated Secondary burden ( $R_{br}$ )	>5kΩ

## Insulation

Insulation type	Dry transformer, air insulation
Highest voltage $U_m$	0.72kV r.m.s.
Rated insulation level	3kV r.m.s. 50Hz/1 min

## Environmental Conditions

Reference temperature	23°C ±1°C
Nominal temperature range	-25°C...40°C
Daily mean temperature	≤30°C
Limit temperature range for storage	-40°C...85°C
Relative humidity	≤85% non condensing

## Housing

Housing material	Self extinguishing polycarbonate
Protection degree (IEC/EN60529)	IP40 housing, Terminals IP20
Mounting	Foot mounting, busbar mounting or snap on 35mm DIN rail mounting
Weight	680g

## Connections

Primary winding	Passing cable
Secondary winding	RJ45 connection

## Dimensions (mm)

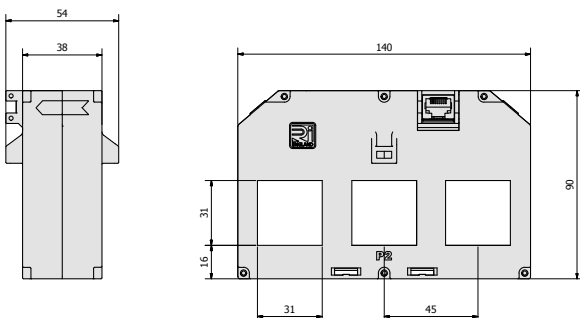

## Accessories

All **easywire**® 3 phase Current Transformers come supplied with fixing feet, busbar clamping screws with insulator feet, a robust DIN rail mounting clip and RJ45 connection anti-tamper seals.



## Information Required with Order

Build your order number - example	RI-CT248-EW 0400 - V
Model	
Primary Current Range - See Parameters Table 'Order Code'	
* Vertical RJ45 Option - for Vertical RJ45 connection add suffix '- V'	

\* Vertical option is to order only.